

SHOWN ZC2PK

A-A

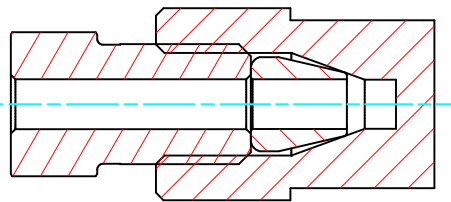

Dimension in mm [Inch]

Part#	Description	L1	L2	L3	X1	X2	D
ZC.5FPK	Cap, ZDV: 1/32"	~17.2 mm [ -0.675" ]	9.65 mm [ 0.380" ]	~7.5 mm [ -0.295" ]	Diamond knurl	Ø6.35 mm [ Ø0.25" ]	Ø6.35 mm [ Ø0.25" ]
ZC1FPK	Cap, ZDV: 1/16"	~30.5 mm [ -1.200" ]	11.68 mm [ 0.460" ]	~18.7 mm [ -0.740" ]	Diamond knurl	Ø9.65 mm [ Ø0.38" ]	Ø9.53 mm [ Ø0.375" ]
ZC1PK	Cap, ZDV: 1/16"	~19.7 mm [ -0.773" ]	11.68 mm [ 0.460" ]	~8.0 mm [ -0.313" ]	7.93 mm [ 0.312" ]	6.35 mm Hex [ 1/4" Hex ]	Ø9.53 mm [ Ø0.375" ]
ZC2PK	Cap, ZDV: 1/8"	~28.1mm [ -1.108" ]	18.42 mm [ 0.725" ]	~9.7 mm [ -0.383" ]	11.1 mm [ 0.437" ]	9.53 mm Hex [ 3/8" Hex ]	Ø12.7 mm [ Ø0.50" ]

THIS DOCUMENT AND THE INFORMATION WHICH IT CONTAINS SHALL NOT BE USED, EXPLOITED OR SOLD, AND SHALL NOT BE REVEALED OR DISCLOSED TO OTHERS WITHOUT THE EXPRESS WRITTEN PERMISSION OF VICI. THIS DOCUMENT SHALL REMAIN THE PROPERTY OF VICI AND SHALL BE RETURNED UPON DEMAND.

Material  
MATERIAL

Dimensionen  
DIMENSIONS

Aenderungen:  
MODIFICATIONS:

PART NO.:

Projektion  
PROJECTION

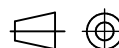

Allgemein Toleranzen  
GENERAL TOLERANCES

SN EN 22768-1/ ISO 2768

**Caps  
Polymeric**

General dimensions

Masstab  
SCALE

2:1

Gezeichnet  
DRAWN

05.01.2006

F.P.

Geprüft / Freigabe  
CHECKED/ RELEASE

05.01.2006

FCo

CAD Nr.  
CAD NO.

506068.idw

Unterverz.:  
SUB DIREC.:

KUNDE

Zeichnungs Nr. / DRAWING NO.

**4 - GE - 5060.68**

**VICI®**

VICI AG International, CH-6214 Schenkon