



Model 300 Flow Controller

The Model 300 is our *downstream*-referenced flow controller, maintaining a constant flow rate as long as the outlet pressure remains constant. (Most users allow the gas to be released at atmospheric pressure.) While the supply pressure might fluctuate from variations in sampling pressure or from chemical reactions taking place, the flow rate remains stable.

Specifications

Maximum flow may be as low as 100 mL/min or as high as 1.5 L/min. Maximum operating pressure is 200 psi; maximum temperature is 120°C.

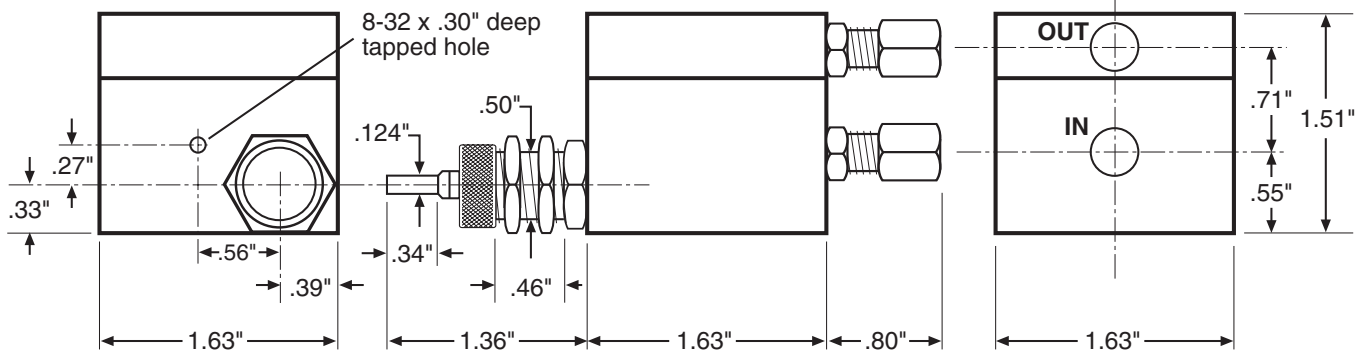
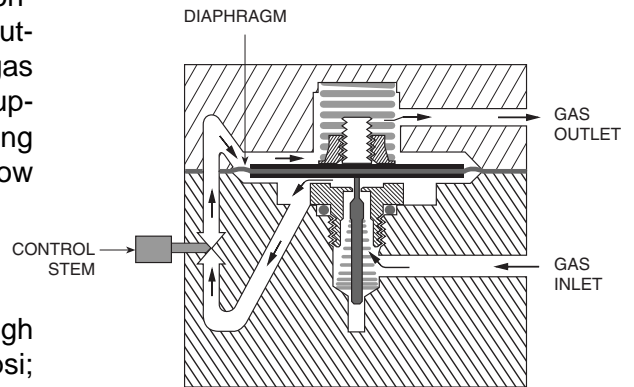

Dimensions

Flow Rates

The Model 300 will accurately maintain the set flow rate in spite of fluctuating upstream pressure – even if the fluctuation is to within 7.5 psi of the outlet pressure. When the flow controller is equipped with the optional Spectrol digital dial, settings are reproducible to better than 1%.

NOTE:

With all our flow controllers, the inlet pressure must exceed the outlet pressure by 10 psi.

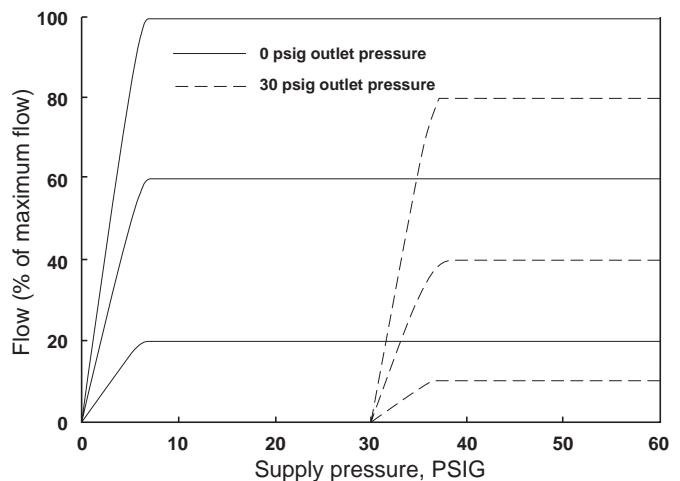

Flow Characteristics

At 40 psig nitrogen

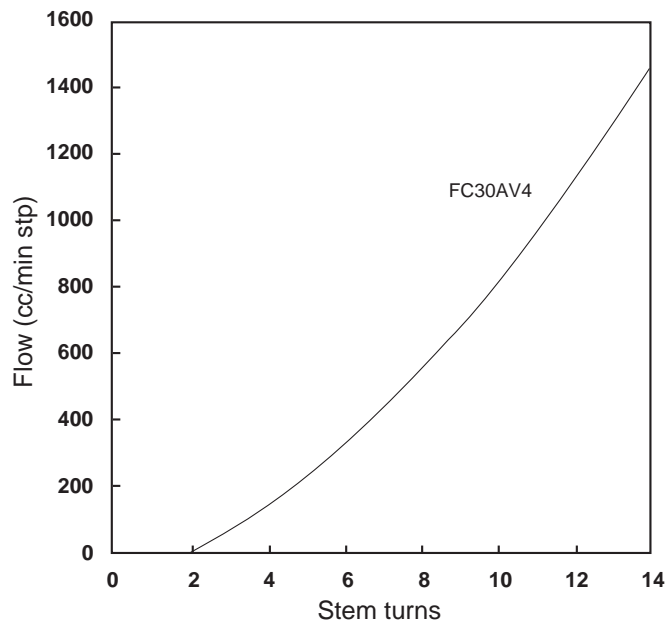
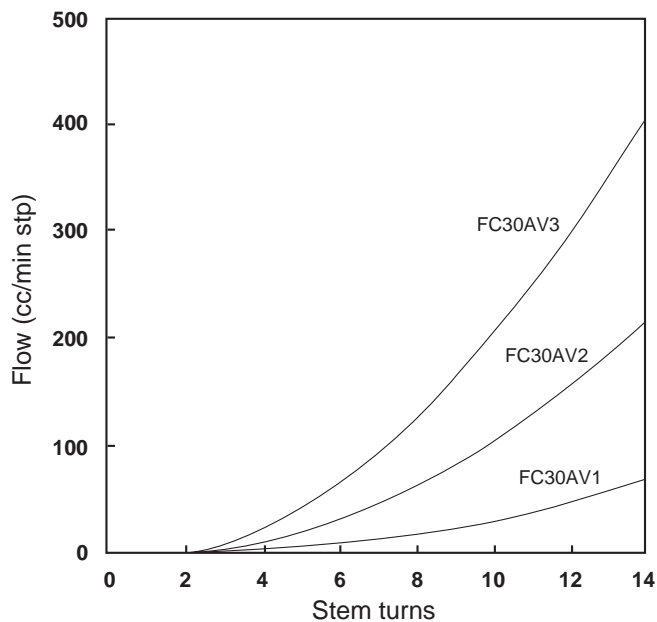

North America, South America, and Australia/Oceania contact:

VICI® Valco Instruments Co. Inc.
P.O. Box 55603
Houston, TX 77255
Sales: (800) 367-8424
Tech: (713) 688-9345
Fax: (713) 688-8106 valco@vici.com

Europe, Asia, and Africa contact:

VICI® VICI AG International
Parkstrasse 2
CH-6214 Schenkon
Switzerland
Phone: +41 41 925 6200
Fax: +41 41 925 6201 info@vici.ch

Cheminer® and VICI® are registered trademarks of Valco Instruments Co. Inc. and VICI AG

TN-615 1/11